

US Army Corps of Engineers
Jacksonville District

SAFETY ON THIS JOB
DEPENDS ON YOU

DEPARTMENT OF THE ARMY
JACKSONVILLE DISTRICT, CORPS OF ENGINEERS
JACKSONVILLE, FLORIDA

Checked by:
GMR

Designed by:
WRM
DWN: JTC

File No.: W02255-00-00-000-000
Date: OCT 2021

XXXXXXXXXXXXXXXXXXXX
XXXXXXXXXXXXXXXXXXXX
XXXXXXXXXXXXXXXXXXXX
XXXXXXXXXXXXXXXXXXXX
XXXXXXXXXXXXXXXXXXXX
XXXXXXXXXXXXXXXXXXXX
XXXXXXXXXXXXXXXXXXXX
XXXXXXXXXXXXXXXXXXXX
XXXXXXXXXXXXXXXXXXXX
XXXXXXXXXXXXXXXXXXXX
XXXXXXXXXXXXXXXXXXXX

Reference files:
21-265-0-10884_BV.DGN

INTRACOASTAL WATERWAY
JACKSONVILLE TO MIAMI, FLORIDA
BREVARD COUNTY
HYDROGRAPHIC EXAM SURVEY FY21
12-FOOT PROJECT
STA. 181+00 THRU STA. 214+00 CUT BV-26
PLAN

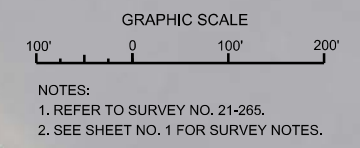

Scale: AS SHOWN
Drawing no.
84
SHEET 84 OF 111



 US Army Corps of Engineers

 Jacksonville District

 SAFETY ON THIS JOB

 DEPENDS ON YOU

DEPARTMENT OF THE ARMY

 JACKSONVILLE DISTRICT, CORPS OF ENGINEERS

 JACKSONVILLE, FLORIDA

Drawn by: WRM
 Check by: GHR
 Date: OCT 2021
 File name: 21-265-HYRBE_BV.DGN

INTRACOASTAL WATERWAY
 JACKSONVILLE TO MIAMI, FLORIDA
 BREVARD COUNTY
HYDROGRAPHIC EXAM SURVEY FY21
12-FOOT PROJECT
 STA. 214+00 THRU STA. 247+00 CUT BV-26
PLAN

Scale: AS SHOWN
 Drawing no.
85
 SHEET 85 OF 111

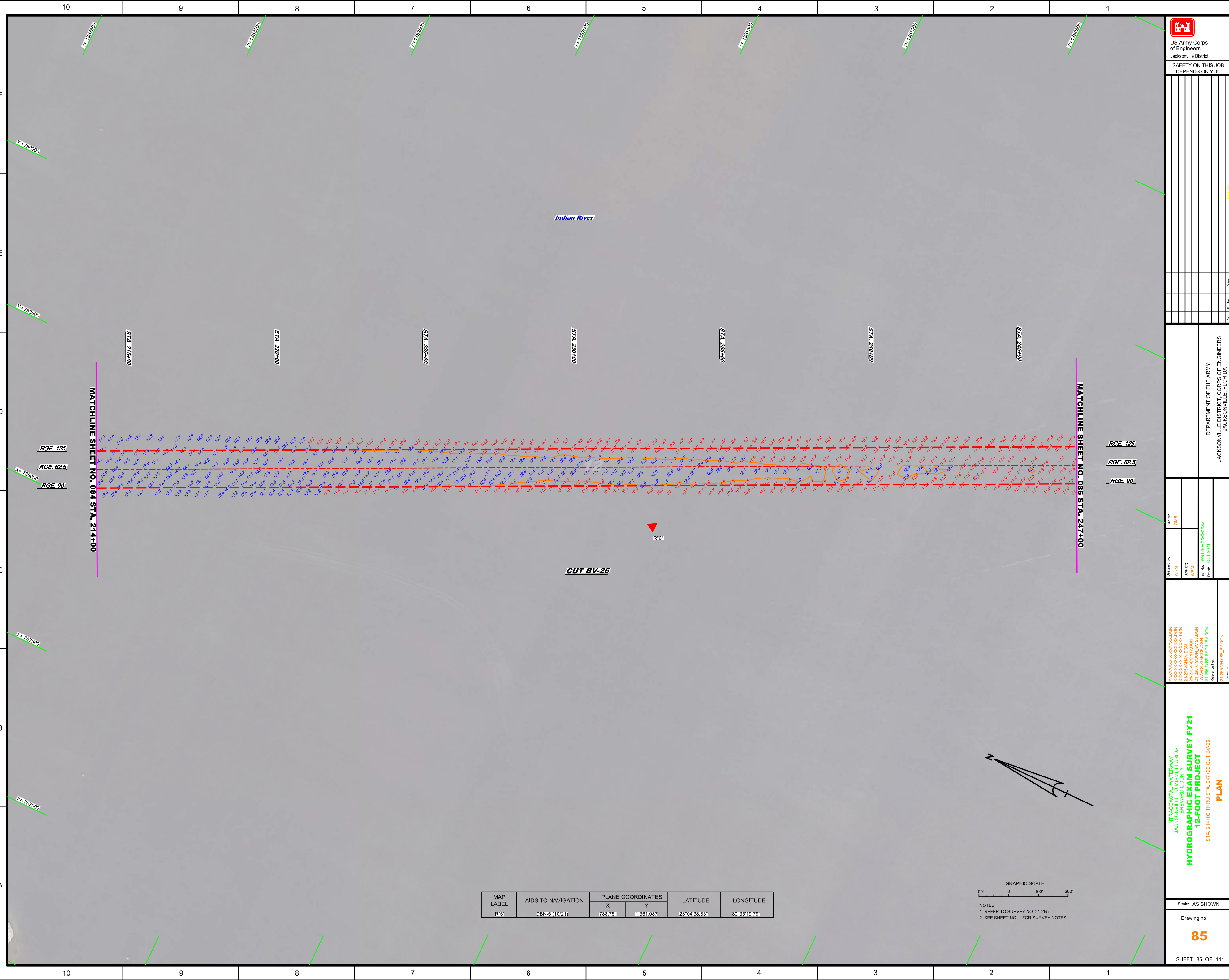

MAP LABEL	AIDS TO NAVIGATION	PLANE COORDINATES		LATITUDE	LONGITUDE
		X	Y		
R'6"	DBN-8 (10/21)	788,751	1,361,087	28°04'38.83"	80°35'19.79"

GRAPHIC SCALE
 100' 0 100' 200'
 NOTES:
 1. REFER TO SURVEY NO. 21-265.
 2. SEE SHEET NO. 1 FOR SURVEY NOTES.

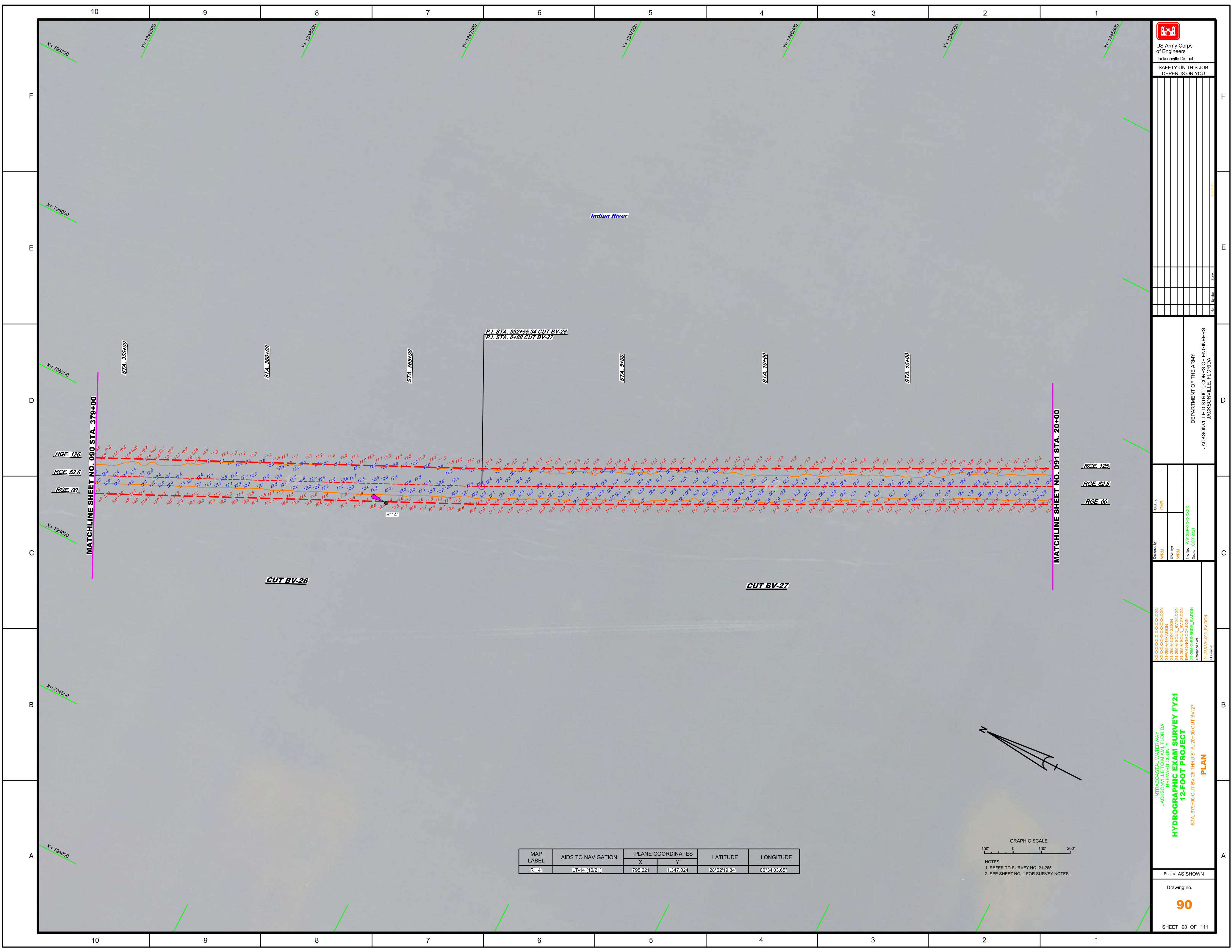

No.	Symbol	Zone

DEPARTMENT OF THE ARMY
JACKSONVILLE DISTRICT, CORPS OF ENGINEERS
JACKSONVILLE, FLORIDA

Checked by: GHR
Designed by: WRM
Drawn by: WRM
File No: W1225A-CAD-000000
Date: OCT 2021
XXXXXXXXXXXXXXXXXXXX
XXXXXXXXXXXXXXXXXXXX
2-1225A-CAD-000000
2-1225A-CAD-000000
2-1225A-CAD-000000
2-1225A-CAD-000000
2-1225A-CAD-000000
Reference files:
2-1225A-CAD-000000
2-1225A-CAD-000000

MAP LABEL	AIDS TO NAVIGATION	PLANE COORDINATES		LATITUDE	LONGITUDE
		X	Y		
R-14*	LT-14 (10/21)	795.621	1,347,024	28°02'19.34"	80°34'03.65"

GRAPHIC SCALE
100' 0 100' 200'
NOTES:
1. REFER TO SURVEY NO. 21-265.
2. SEE SHEET NO. 1 FOR SURVEY NOTES.

INTRACASTAL WATERWAY
JACKSONVILLE TO MIAMI, FLORIDA
BREVARD COUNTY
HYDROGRAPHIC EXAM SURVEY FY21
12-FOOT PROJECT
STA. 379+00 CUT BV-26 THRU STA. 20+00 CUT BV-27
PLAN

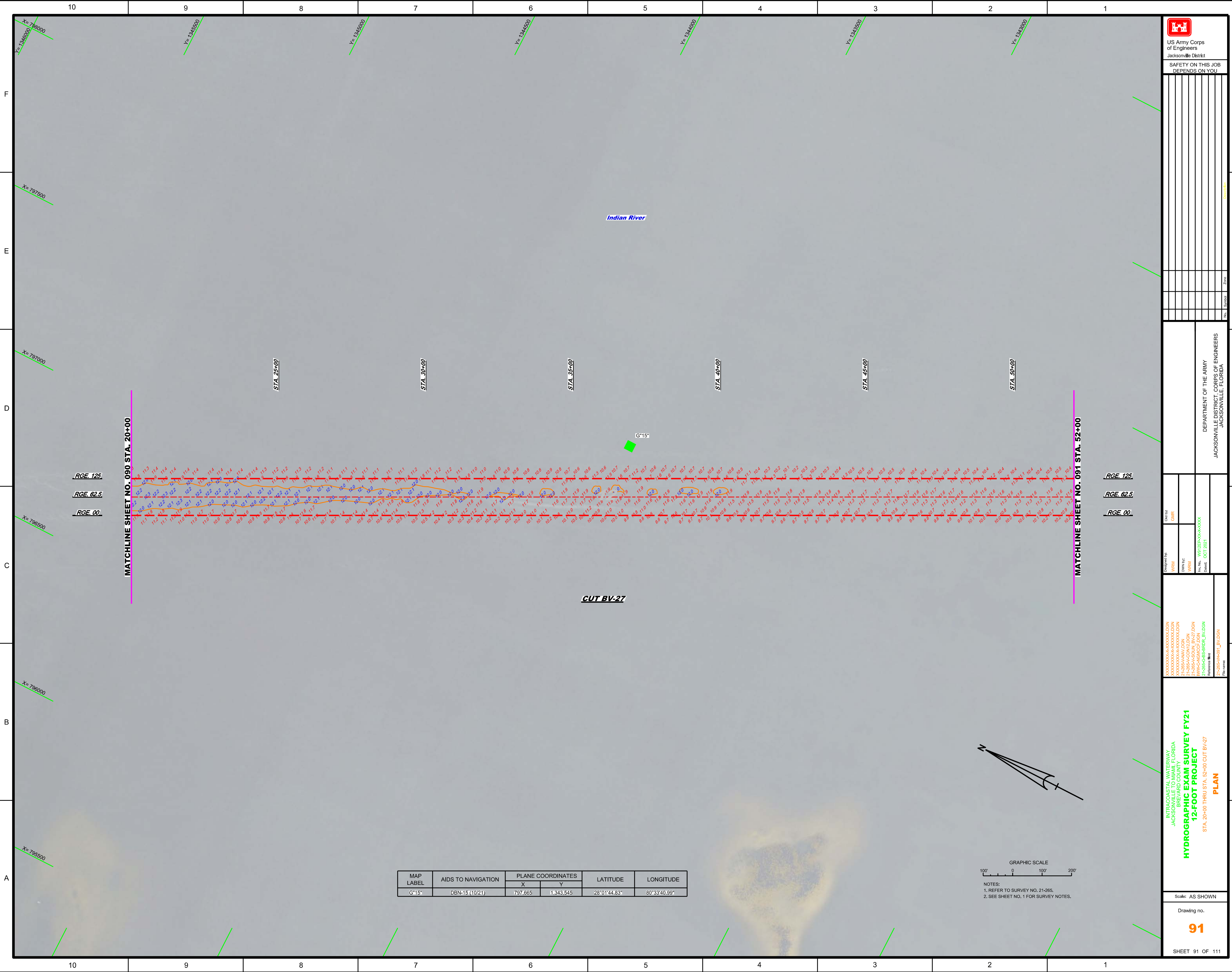

MAP LABEL	AIDS TO NAVIGATION	PLANE COORDINATES		LATITUDE	LONGITUDE
		X	Y		
G*15*	DBN-15 (10/21)	797.665	1,343.545	28°01'44.83"	80°33'40.99"

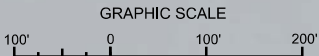

NOTES:
 1. REFER TO SURVEY NO. 21-265.
 2. SEE SHEET NO. 1 FOR SURVEY NOTES.

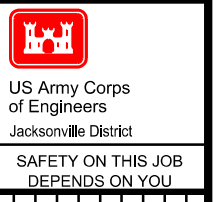

US Army Corps of Engineers
 Jacksonville District

SAFETY ON THIS JOB
 DEPENDS ON YOU

NO.	SYMBOL	ZONE

DEPARTMENT OF THE ARMY
 JACKSONVILLE DISTRICT, CORPS OF ENGINEERS
 JACKSONVILLE, FLORIDA

Checked By: GHR
 Designed By: WRM
 Drawn By: WRM
 Plot Date: 08/22/2021 10:44:00 AM
 Date: OCT 2021

XXXXXXXXXXXXXXXXXXXX.DGN
 XXXXXXXXXXXXXXXXXXXX.DGN
 XXXXXXXXXXXXXXXXXXXX.DGN
 21-265-AN-CON-12.DGN
 21-265-CON-02.DGN
 21-265-CON-03.DGN
 21-265-CON-04.DGN
 21-265-CON-05.DGN
 21-265-CON-06.DGN
 21-265-CON-07.DGN
 21-265-CON-08.DGN
 21-265-CON-09.DGN
 21-265-CON-10.DGN
 21-265-CON-11.DGN
 21-265-CON-12.DGN
 21-265-CON-13.DGN
 21-265-CON-14.DGN
 21-265-CON-15.DGN
 21-265-CON-16.DGN
 21-265-CON-17.DGN
 21-265-CON-18.DGN
 21-265-CON-19.DGN
 21-265-CON-20.DGN
 21-265-CON-21.DGN
 21-265-CON-22.DGN
 21-265-CON-23.DGN
 21-265-CON-24.DGN
 21-265-CON-25.DGN
 21-265-CON-26.DGN
 21-265-CON-27.DGN
 21-265-CON-28.DGN
 21-265-CON-29.DGN
 21-265-CON-30.DGN
 21-265-CON-31.DGN
 21-265-CON-32.DGN
 21-265-CON-33.DGN
 21-265-CON-34.DGN
 21-265-CON-35.DGN
 21-265-CON-36.DGN
 21-265-CON-37.DGN
 21-265-CON-38.DGN
 21-265-CON-39.DGN
 21-265-CON-40.DGN
 21-265-CON-41.DGN
 21-265-CON-42.DGN
 21-265-CON-43.DGN
 21-265-CON-44.DGN
 21-265-CON-45.DGN
 21-265-CON-46.DGN
 21-265-CON-47.DGN
 21-265-CON-48.DGN
 21-265-CON-49.DGN
 21-265-CON-50.DGN
 21-265-CON-51.DGN
 21-265-CON-52.DGN
 21-265-CON-53.DGN
 21-265-CON-54.DGN
 21-265-CON-55.DGN
 21-265-CON-56.DGN
 21-265-CON-57.DGN
 21-265-CON-58.DGN
 21-265-CON-59.DGN
 21-265-CON-60.DGN
 21-265-CON-61.DGN
 21-265-CON-62.DGN
 21-265-CON-63.DGN
 21-265-CON-64.DGN
 21-265-CON-65.DGN
 21-265-CON-66.DGN
 21-265-CON-67.DGN
 21-265-CON-68.DGN
 21-265-CON-69.DGN
 21-265-CON-70.DGN
 21-265-CON-71.DGN
 21-265-CON-72.DGN
 21-265-CON-73.DGN
 21-265-CON-74.DGN
 21-265-CON-75.DGN
 21-265-CON-76.DGN
 21-265-CON-77.DGN
 21-265-CON-78.DGN
 21-265-CON-79.DGN
 21-265-CON-80.DGN
 21-265-CON-81.DGN
 21-265-CON-82.DGN
 21-265-CON-83.DGN
 21-265-CON-84.DGN
 21-265-CON-85.DGN
 21-265-CON-86.DGN
 21-265-CON-87.DGN
 21-265-CON-88.DGN
 21-265-CON-89.DGN
 21-265-CON-90.DGN
 21-265-CON-91.DGN
 21-265-CON-92.DGN
 21-265-CON-93.DGN
 21-265-CON-94.DGN
 21-265-CON-95.DGN
 21-265-CON-96.DGN
 21-265-CON-97.DGN
 21-265-CON-98.DGN
 21-265-CON-99.DGN
 21-265-CON-100.DGN
 21-265-CON-101.DGN
 21-265-CON-102.DGN
 21-265-CON-103.DGN
 21-265-CON-104.DGN
 21-265-CON-105.DGN
 21-265-CON-106.DGN
 21-265-CON-107.DGN
 21-265-CON-108.DGN
 21-265-CON-109.DGN
 21-265-CON-110.DGN
 21-265-CON-111.DGN
 21-265-CON-112.DGN
 21-265-CON-113.DGN
 21-265-CON-114.DGN
 21-265-CON-115.DGN
 21-265-CON-116.DGN
 21-265-CON-117.DGN
 21-265-CON-118.DGN
 21-265-CON-119.DGN
 21-265-CON-120.DGN
 21-265-CON-121.DGN
 21-265-CON-122.DGN
 21-265-CON-123.DGN
 21-265-CON-124.DGN
 21-265-CON-125.DGN
 21-265-CON-126.DGN
 21-265-CON-127.DGN
 21-265-CON-128.DGN
 21-265-CON-129.DGN
 21-265-CON-130.DGN
 21-265-CON-131.DGN
 21-265-CON-132.DGN
 21-265-CON-133.DGN
 21-265-CON-134.DGN
 21-265-CON-135.DGN
 21-265-CON-136.DGN
 21-265-CON-137.DGN
 21-265-CON-138.DGN
 21-265-CON-139.DGN
 21-265-CON-140.DGN
 21-265-CON-141.DGN
 21-265-CON-142.DGN
 21-265-CON-143.DGN
 21-265-CON-144.DGN
 21-265-CON-145.DGN
 21-265-CON-146.DGN
 21-265-CON-147.DGN
 21-265-CON-148.DGN
 21-265-CON-149.DGN
 21-265-CON-150.DGN
 21-265-CON-151.DGN
 21-265-CON-152.DGN
 21-265-CON-153.DGN
 21-265-CON-154.DGN
 21-265-CON-155.DGN
 21-265-CON-156.DGN
 21-265-CON-157.DGN
 21-265-CON-158.DGN
 21-265-CON-159.DGN
 21-265-CON-160.DGN
 21-265-CON-161.DGN
 21-265-CON-162.DGN
 21-265-CON-163.DGN
 21-265-CON-164.DGN
 21-265-CON-165.DGN
 21-265-CON-166.DGN
 21-265-CON-167.DGN
 21-265-CON-168.DGN
 21-265-CON-169.DGN
 21-265-CON-170.DGN
 21-265-CON-171.DGN
 21-265-CON-172.DGN
 21-265-CON-173.DGN
 21-265-CON-174.DGN
 21-265-CON-175.DGN
 21-265-CON-176.DGN
 21-265-CON-177.DGN
 21-265-CON-178.DGN
 21-265-CON-179.DGN
 21-265-CON-180.DGN
 21-265-CON-181.DGN
 21-265-CON-182.DGN
 21-265-CON-183.DGN
 21-265-CON-184.DGN
 21-265-CON-185.DGN
 21-265-CON-186.DGN
 21-265-CON-187.DGN
 21-265-CON-188.DGN
 21-265-CON-189.DGN
 21-265-CON-190.DGN
 21-265-CON-191.DGN
 21-265-CON-192.DGN
 21-265-CON-193.DGN
 21-265-CON-194.DGN
 21-265-CON-195.DGN
 21-265-CON-196.DGN
 21-265-CON-197.DGN
 21-265-CON-198.DGN
 21-265-CON-199.DGN
 21-265-CON-200.DGN
 21-265-CON-201.DGN
 21-265-CON-202.DGN
 21-265-CON-203.DGN
 21-265-CON-204.DGN
 21-265-CON-205.DGN
 21-265-CON-206.DGN
 21-265-CON-207.DGN
 21-265-CON-208.DGN
 21-265-CON-209.DGN
 21-265-CON-210.DGN
 21-265-CON-211.DGN
 21-265-CON-212.DGN
 21-265-CON-213.DGN
 21-265-CON-214.DGN
 21-265-CON-215.DGN
 21-265-CON-216.DGN
 21-265-CON-217.DGN
 21-265-CON-218.DGN
 21-265-CON-219.DGN
 21-265-CON-220.DGN
 21-265-CON-221.DGN
 21-265-CON-222.DGN
 21-265-CON-223.DGN
 21-265-CON-224.DGN
 21-265-CON-225.DGN
 21-265-CON-226.DGN
 21-265-CON-227.DGN
 21-265-CON-228.DGN
 21-265-CON-229.DGN
 21-265-CON-230.DGN
 21-265-CON-231.DGN
 21-265-CON-232.DGN
 21-265-CON-233.DGN
 21-265-CON-234.DGN
 21-265-CON-235.DGN
 21-265-CON-236.DGN
 21-265-CON-237.DGN
 21-265-CON-238.DGN
 21-265-CON-239.DGN
 21-265-CON-240.DGN
 21-265-CON-241.DGN
 21-265-CON-242.DGN
 21-265-CON-243.DGN
 21-265-CON-244.DGN
 21-265-CON-245.DGN
 21-265-CON-246.DGN
 21-265-CON-247.DGN
 21-265-CON-248.DGN
 21-265-CON-249.DGN
 21-265-CON-250.DGN

INTRACOASTAL WATERWAY
 JACKSONVILLE TO MIAMI, FLORIDA
 BREVARD COUNTY
HYDROGRAPHIC EXAM SURVEY FY21
12-FOOT PROJECT
 STA. 20+00 THRU STA. 52+00 CUT BV-27
PLAN

Scale: AS SHOWN
 Drawing no.
91
 SHEET 91 OF 111

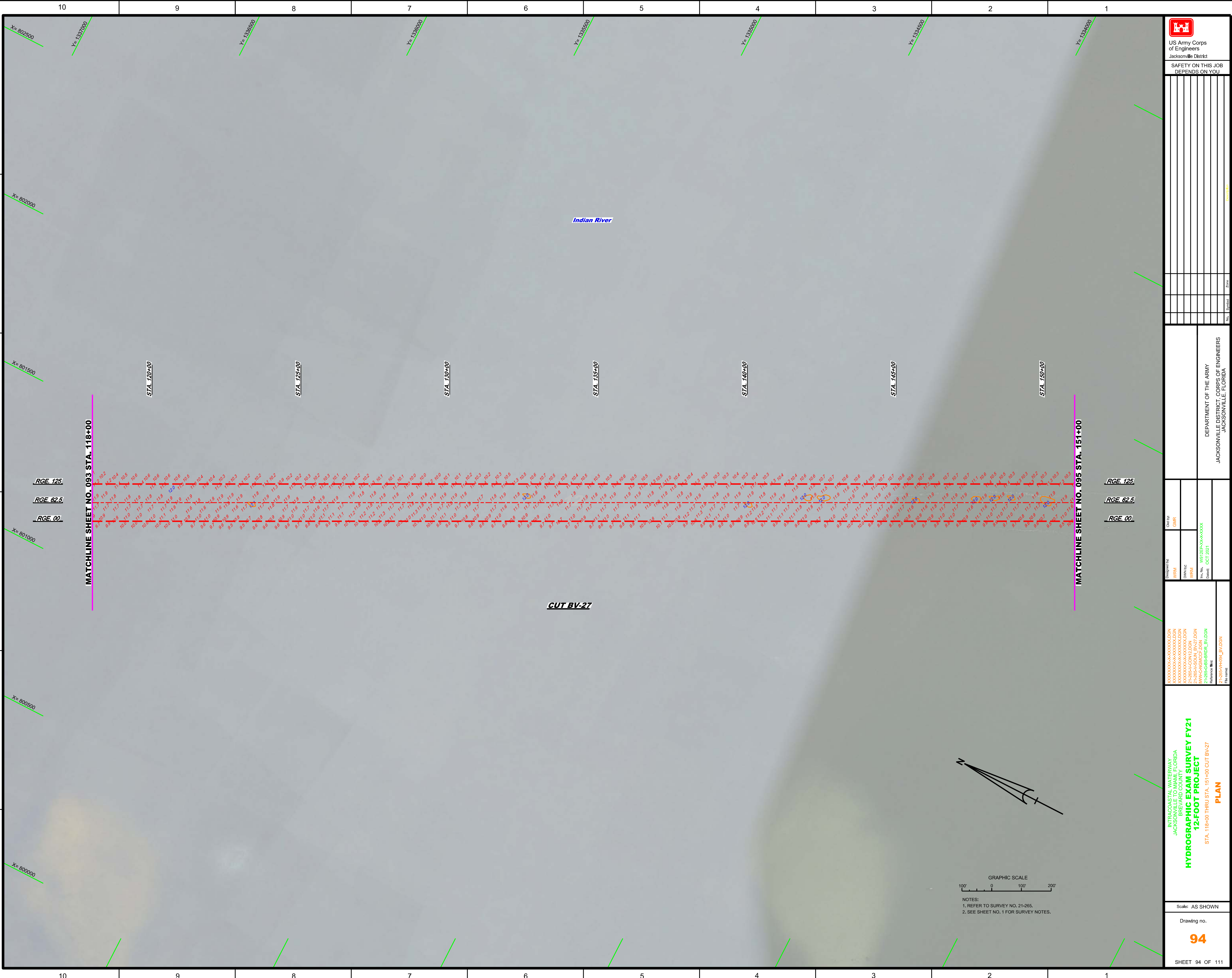

US Army Corps of Engineers
Jacksonville District

SAFETY ON THIS JOB
DEPENDS ON YOU

No.	Symbol	Zone

DEPARTMENT OF THE ARMY
JACKSONVILLE DISTRICT, CORPS OF ENGINEERS
JACKSONVILLE, FLORIDA

Checked by: GHR
Designed by: WRM
Drawn by: WRM
File No.: WJ2252-14-00000
Date: OCT 2021

XXXXXXXXXXXXXXXXXXXX.DGN
XXXXXXXXXXXXXXXXXXXX.DGN
XXXXXXXXXXXXXXXXXXXX.DGN
XXXXXXXXXXXXXXXXXXXX.DGN
XXXXXXXXXXXXXXXXXXXX.DGN
XXXXXXXXXXXXXXXXXXXX.DGN
XXXXXXXXXXXXXXXXXXXX.DGN
XXXXXXXXXXXXXXXXXXXX.DGN
XXXXXXXXXXXXXXXXXXXX.DGN
XXXXXXXXXXXXXXXXXXXX.DGN

**INTRACOSTAL WATERWAY
JACKSONVILLE TO MIAMI, FLORIDA
BREVARD COUNTY
HYDROGRAPHIC EXAM SURVEY FY21
12-FOOT PROJECT
STA. 118+00 THRU STA. 151+00 CUT BV-27**

PLAN

Scale: AS SHOWN
Drawing no. **94**
SHEET 94 OF 111

GRAPHIC SCALE
100' 0 100' 200'
NOTES:
1. REFER TO SURVEY NO. 21-265.
2. SEE SHEET NO. 1 FOR SURVEY NOTES.

10 9 8 7 6 5 4 3 2 1

F
E
D
C
B
A



US Army Corps of Engineers
Jacksonville District
SAFETY ON THIS JOB
DEPENDS ON YOU

Task	Status	Date

DEPARTMENT OF THE ARMY
JACKSONVILLE DISTRICT, CORPS OF ENGINEERS
JACKSONVILLE, FLORIDA

Designed by: WRM	Check by: GHR
Drawn by: WRM	
File No.: W912BFA-000-9-0001	
Contract: OCT 2021	

XXXXXXXXXXXXXXXXXXXX.DGN
XXXXXXXXXXXXXXXXXXXX.DGN
XXXXXXXXXXXXXXXXXXXX.DGN
21-285-BAV-CON12.DGN
21-285-CA-CUT.DGN
21-285-CA-CE.DGN
21-285-CA-SB-RROR_BV.DGN
21-285-CA-HORSE_BV.DGN
Reference files:
21-285-CA-HORSE_BV.DGN

INTRACOASTAL WATERWAY
JACKSONVILLE TO MIAMI, FLORIDA
BREVARD COUNTY
HYDROGRAPHIC EXAM SURVEY FY21
12-FOOT PROJECT
STA. 151+00 THRU STA. 184+00 CUT BV-27
PLAN

Scale: AS SHOWN

Drawing no.
95

MAP LABEL	AIDS TO NAVIGATION	PLANE COORDINATES		LATITUDE	LONGITUDE
		X	Y		
R*18*	DBN-18 (10/21)	802712	1333181	28°00'02.02"	80°32'45.10"

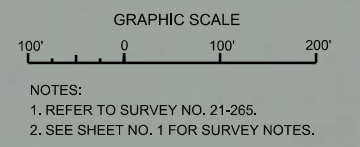

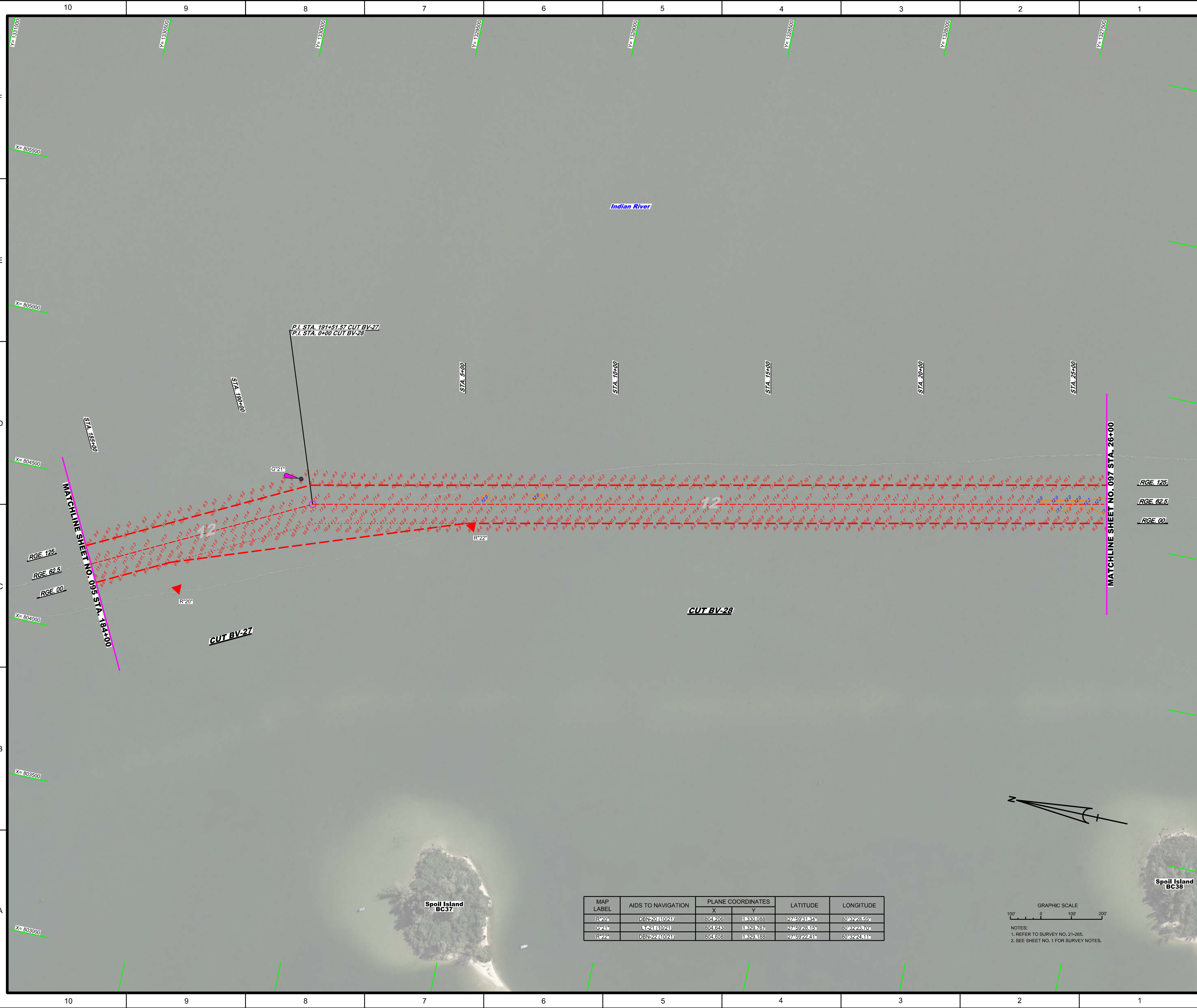

MAP LABEL	AIDS TO NAVIGATION	PLANE COORDINATES		LATITUDE	LONGITUDE
		X	Y		
R*20	DBN-20 (10/21)	804,206	18330,088	27°59'31.84"	80°32'28.55"
G*21	L*21 (10/21)	804,643	18329,767	27°59'28.15"	80°32'23.70"
R*22	DBN-22 (10/21)	804,608	18329,188	27°59'22.41"	80°32'23.11"

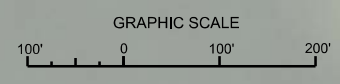
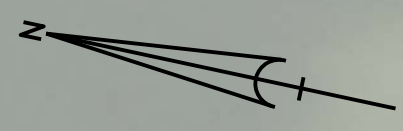

NOTES:
 1. REFER TO SURVEY NO. 21-265.
 2. SEE SHEET NO. 1 FOR SURVEY NOTES.

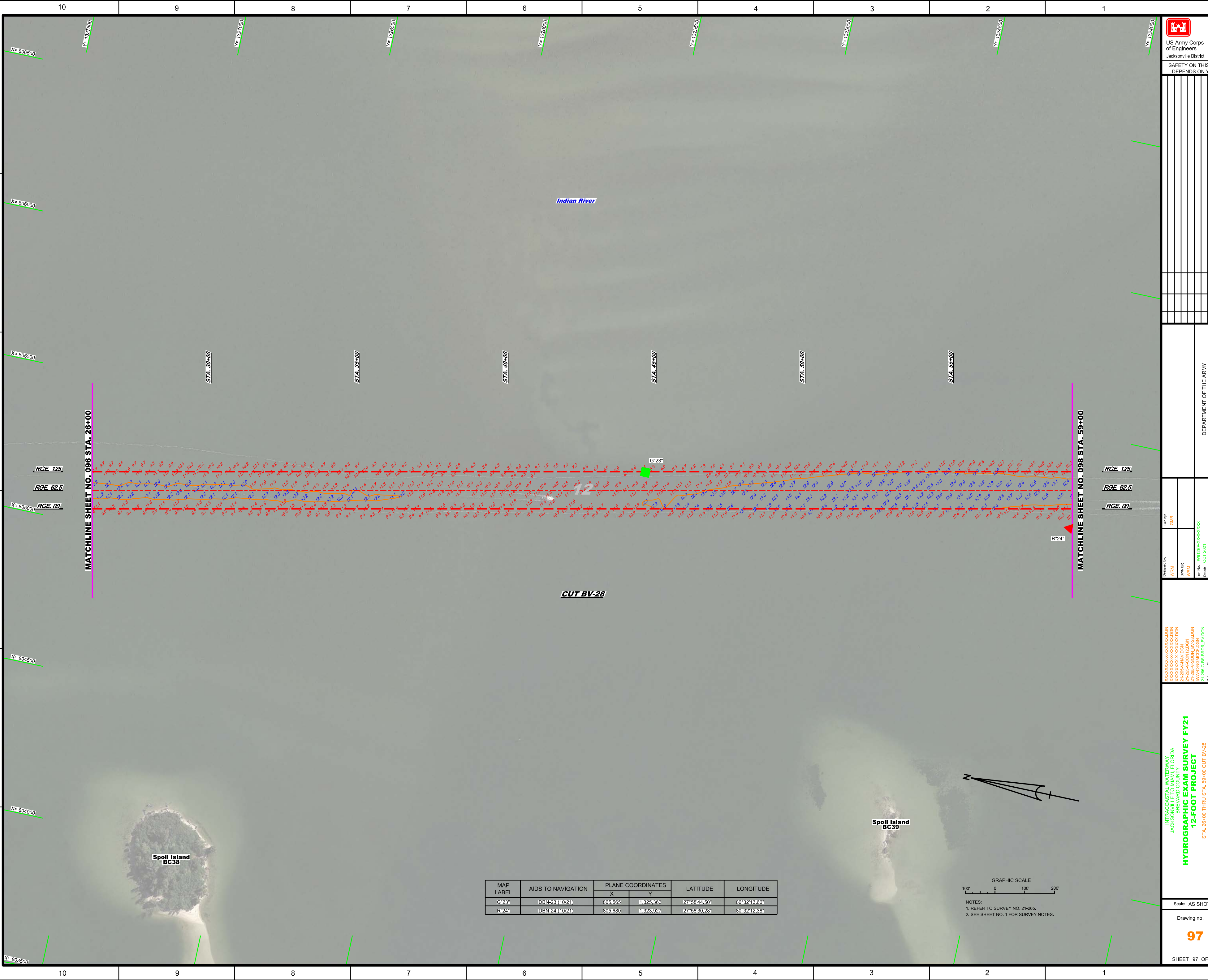

MATCHLINE SHEET NO. 096 STA. 26+00

MATCHLINE SHEET NO. 098 STA. 59+00

CUT BV-28

MAP LABEL	AIDS TO NAVIGATION	PLANE COORDINATES		LATITUDE	LONGITUDE
		X	Y		
G23	DBN-23 (10/21)	805565	1275363	27°59'44.50"	80°32'13.50"
R24	DBN-24 (10/21)	805680	12753927	27°59'30.28"	80°32'12.88"

GRAPHIC SCALE
0 100' 200'

NOTES:
1. REFER TO SURVEY NO. 21-265.
2. SEE SHEET NO. 1 FOR SURVEY NOTES.



US Army Corps of Engineers
Jacksonville District

SAFETY ON THIS JOB DEPENDS ON YOU

DEPARTMENT OF THE ARMY
JACKSONVILLE DISTRICT, CORPS OF ENGINEERS
JACKSONVILLE, FLORIDA

INTRACOASTAL WATERWAY
JACKSONVILLE TO MIAMI, FLORIDA
BREVARD COUNTY
HYDROGRAPHIC EXAM SURVEY FY21
12-FOOT PROJECT
STA. 26+00 THRU STA. 59+00 CUT BV-28

Scale: AS SHOWN
Drawing no.
97

SHEET 97 OF 111

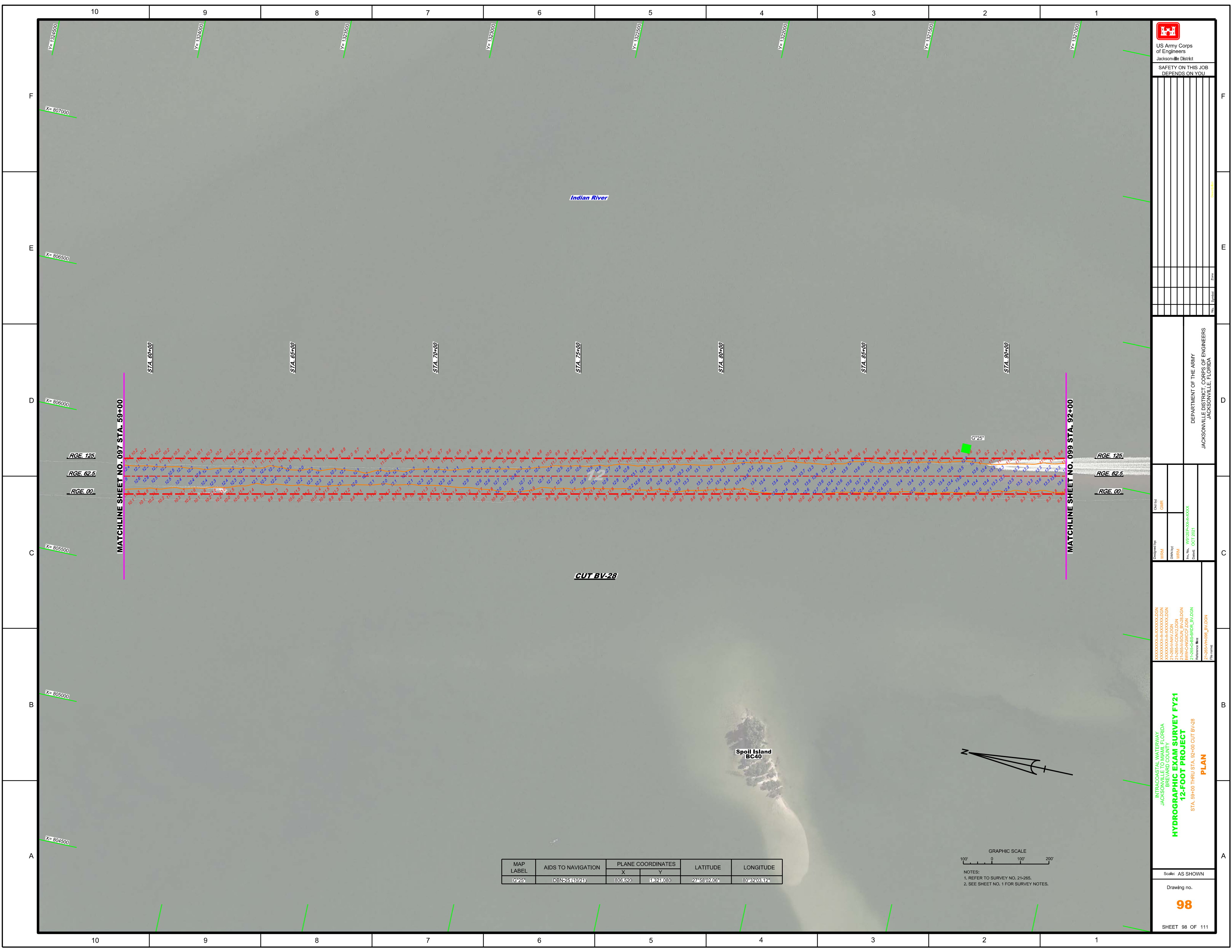

US Army Corps of Engineers
Jacksonville District

SAFETY ON THIS JOB
DEPENDS ON YOU

DEPARTMENT OF THE ARMY
JACKSONVILLE DISTRICT, CORPS OF ENGINEERS
JACKSONVILLE, FLORIDA

Check by: **GHR**

Designed by: **WRM**

DRAWN BY: **WRM**

File No.: **W1255-PAV-PAV-004**

Date: **OCT 2021**

XXXXXXXXXXXXXXXXXXXX.DGN
XXXXXXXXXXXXXXXXXXXX.DGN
XXXXXXXXXXXXXXXXXXXX.DGN
21-265-AV-CON12.DGN
21-265-AV-CAN12.DGN
21-265-AV-CON12.DGN
21-265-AV-CAN12.DGN
21-265-G-BB-SRI04_BV.DGN
21-265-AV-HR06_BV.DGN

INTRACOSTAL WATERWAY
JACKSONVILLE TO MIAMI, FLORIDA
BREVARD COUNTY
HYDROGRAPHIC EXAM SURVEY FY21
12-FOOT PROJECT
STA. 59+00 THRU STA. 92+00 CUT BV-28
PLAN

Scale: AS SHOWN

Drawing no. **98**

SHEET 98 OF 111

MAP LABEL	AIDS TO NAVIGATION	PLANE COORDINATES		LATITUDE	LONGITUDE
		X	Y		
G*25	DBN-25 (10/21)	806520	11321080	27°58'02.06"	80°32'03.12"

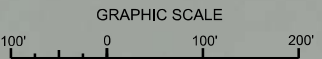

NOTES:
 1. REFER TO SURVEY NO. 21-265.
 2. SEE SHEET NO. 1 FOR SURVEY NOTES.

